



[MÉXICO]
ANTES DE DEVOLVER EL
PRODUCTO A LA TIENDA:

Comuníquese Con Servicio Al
Cliente De Huff. Nos Complace
Ayudarlo Con Cualquier Parte
O Problema De Ensamblado
Que Pudiera Tener.

Para obtener Servicio al cliente
rápido, visite:

<http://www.huffybikes.com/>
O LLAME AL TEL: 01800 1483 391
(Mexico only)

Para comunicarse por correo electrónico:
servicio@huffmex.com

<http://www.huffybikes.com/home/globalcontact>

for current contact information
para obtener la información de contacto actual
pour les informations de contact actuelles

For Assembly Help:
Ayuda de la Asamblea:
Aide à l'assemblage:

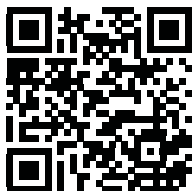

[In the US and Canada]
PLEASE - BEFORE RETURNING TO STORE:

Contact Huff Customer Service. We
are glad to assist you with any parts or
assembly problems you might have!

~
VEUILLEZ NOTER : AVANT DE
RETOURNER AU MAGASIN :

Communiquez Avec Le Service À La
Clientèle De Huff. Nous Vous Aiderons
Volontiers Avec Tout Problème Concernant
Les Pièces Ou Le Montage!

For Fast Customer Service, go to:

Pour un Service à la clientèle rapide, allez sur le site :
<http://www.huffybikes.com/contact>

To Order Parts (US), go to:

Pour obtenir des pièces (CANADA), allez à:
<http://www.huffybikes.com/parts>

OR TEL: 1 800 872 2453 (US only)
OU appelez le 1 800 872 2453 (CANADA seulement)

For email, go to <http://www.huffybikes.com/contact>
Pour communiquer par courriel huffycanada@huffy.com



Date Code Label
Here

HGM-16_G10_EN-AU 06-14-18 m0464
© Copyright Huff Corporation 2018



Owner's Manual

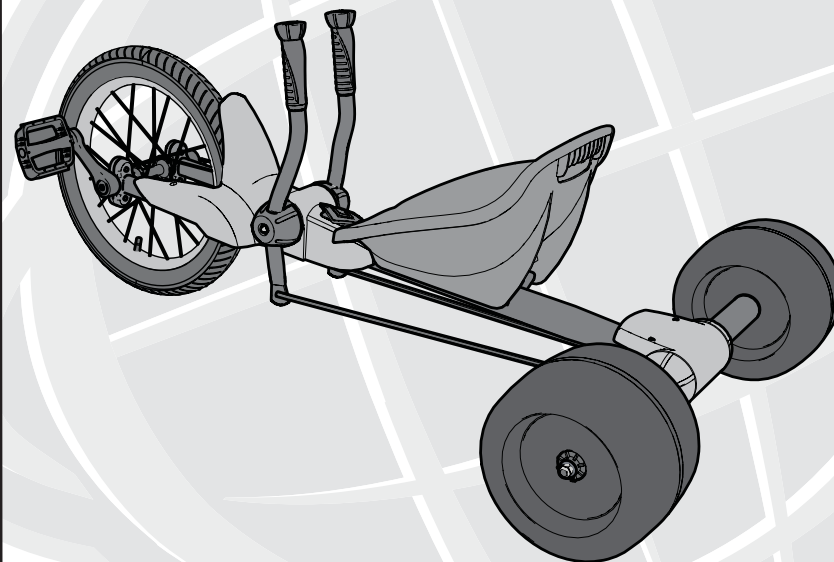

This manual contains important safety, assembly,
operation and maintenance information.
Please read and fully understand this manual before
operation.

Save this manual for future reference.



Always wear approved helmet and safety equipment when
using this product.



See back page for Customer Service Information
Consulte el reverso para Servicio de Información al Cliente
Voir pages verso pour des renseignements le service à la Clientèle

H-Tri_STOP-Global_010318_i0388

Your Green Machine

• Warning and Safety Information.....	3-4
• Helmet Warning Information	5
• Owner's Model Identification Record.....	6
• Assembly Notes - Tools Needed	6
• Special Handling Methods	7
• Operating Your Green Machine	8-9

Model Assembly

• Parts Assembly List.....	10-11
• Assemble Front Frame to Rear Frame	12
• Assemble Steering Linkage.....	13-15
• Assemble Rear Steering Axle.....	14-15
• Assemble Rear Wheels	16
• Installing Seat.....	17
• Installing Pedals	18
• Installing Rear Axle Cover	18

Maintenance and Service

• Repair and Service.....	19
• Tires	20
• Lubrication and Lubrication Table.....	21
• Torque Table	22

Warranty

• Corporation Limited Warranty	23
--------------------------------------	----

• Contact Information	back cover
-----------------------------	------------

! WARNING:

- CHOKING HAZARD: Small parts. Not for children under 3 years. Adult assembly required. Keep small children away when assembling.
- The user must be **5-8 years**, and weigh no more than **80 lbs (36kgs)**.

! IMPORTANT!! BEFORE YOUR FIRST RIDE:

- Read entire manual, including all safety warnings.
- Check Tire Pressure.

Limited Warranty

General:

Part or model specifications are subject to change without notice.

This Limited Warranty is the only warranty for the product. ALL WARRANTIES OTHER THAN STATED HEREIN ARE DISCLAIMED INCLUDING IMPLIED WARRANTIES OF MERCHANTABILITY AND FITNESS FOR A PARTICULAR PURPOSE, TO THE EXTENT ALLOWABLE BY APPLICABLE LAW. ALL LIABILITY FOR INCIDENTAL, PUNITIVE, SPECIAL, OR CONSEQUENTIAL DAMAGES ARE EXPRESSLY DISCLAIMED, TO THE EXTENT ALLOWABLE BY APPLICABLE LAW.

The only uses for this product are described in this manual.

Warranty registration is not required.

The Limited Warranty extends only to the original consumer and is not transferable to anyone else.

What does this Limited Warranty cover?

This Limited Warranty covers defects in workmanship and materials for all parts of the product except those indicated below as not warranted.

What must you do to keep the Limited Warranty in effect?

This Limited Warranty is effective only if:

- Product is completely and correctly assembled.
- Product is used under normal conditions for its intended purpose (see the following section for excluded activities).
- Product receives all necessary maintenance and adjustments.
- Product is used for general transportation and recreational use only.

What is not covered by this Limited Warranty?

This product is designed for recreational use only. This Limited Warranty does not cover normal wear and tear, normal maintenance items, or any damage, failure, or loss that is caused by improper assembly, maintenance, adjustment, storage, or use of the product. This Limited Warranty does not extend to future performance.

This Limited Warranty will be void if the product is ever:

- Used in any competitive sport
- Used for stunt riding, jumping, aerobatics or similar activity
- Modified in any way
- Modified with the addition of a motor

- Ridden by more than one person at a time
- Rented, sold, or given away
- Used in a manner contrary to the instructions and warnings in this Owner's Manual

What will The Manufacturer do?

Manufacturer's sole and exclusive obligation under this Limited Warranty is to repair and/or replace, at its sole option, any covered defect in workmanship or materials.

What rights do you have?

This Limited Warranty gives you specific legal rights. You may also have other rights which vary from State to State.

CONTACTING CUSTOMER SERVICE:

How do you report a problem with this product or submit a warranty claim?

- Contact Consumer Service - See included list for Customer Contact information.

IN AUSTRALIA:

- Warranty claims can be submitted to; Hunter Products Pty Ltd - PH: 1800 224 094
Email: enquiries@hunterproducts.com.au - Level 2, 424 Warrigal Road, Moorabbin, Victoria 3189 Australia.

The following text is incorporated into this Limited Warranty if this product was purchased in Australia (but it is not incorporated if such product was purchased in New Zealand):

- Our goods come with guarantees that cannot be excluded under the Australian Consumer Law. You are entitled to a replacement or refund for a major failure and for compensation for any other reasonably foreseeable loss or damage. You are also entitled to have the goods repaired or replaced if the goods fail to be of acceptable quality and the failure does not amount to a major failure.

For how long does this Limited Warranty last?

- When used in this Limited Warranty, the phrase "for life" means for as long as the original consumer owns the product.
- Warranty is from date of purchase.
- Frame and all components are warranted for six (6) months.
- Resin wheels are not warranted.

Torque Table (Australia)

Recommended Torque:

Use of a torque wrench is recommended. Recommended torque for each fastener is listed below. In addition to tightening to the recommended torque, please ensure the parts of the product are sufficiently tightened by performing the functional tests (in the component assembly sections of the owner's manual) on each component as it is tightened.

NOTE: Please check that all fasteners on the product are torqued according to the table below:

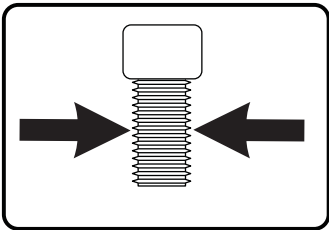
Recommended Torque for clean, dry threads:		How to Measure:
Fastener Size	Torque (ft-lb / N•m)	Screw or bolt size is determined by the width at the THREADS as shown.
.157 in (4 mm)	3.1 ft-lbs (4.2 N•m)	
.196 in (5 mm)	5 ft-lbs (6.8 N•m)	
.236 in (6 mm)	7 ft-lb (9.5 N•m)	
.275 in (7 mm)	12 ft-lbs (16.3 N•m)	
.314 in (8 mm)	17 ft-lbs (23 N•m)	
.393 in (10 mm)	33 ft-lbs (44.7 N•m)	
Pedals (if equipped)	24 ft-lbs (30 N•m)	

Warning and Safety Information

PLEASE READ AND FULLY UNDERSTAND THIS OWNERS MANUAL BEFORE OPERATING THE PRODUCT



This symbol is important. See the word "**CAUTION**" or "**WARNING**" which follows it. The word "**CAUTION**" is before mechanical instructions. If you do not obey these instructions, mechanical damage or failure of a part of the product can occur. The word "**WARNING**" is before personal safety instructions. If you do not obey these instructions, injury to the rider or to others can occur.

All wheeled vehicles will provide safe, enjoyable transportation and recreation when used and maintained properly. Like bicycling, skateboarding, and in-line skating, riding can be dangerous even under the best of circumstances. We do not want you to get hurt. Please follow all safety rules and operating instructions.

This toy should be used with caution since skill is required to avoid falls or collisions causing injury to the user or third parties.



WARNINGS - ASSEMBLY:

Wheels, Tire & Axle:

- The rear axle nuts must be securely tightened to ensure rear wheels do not come loose from the axle.
- All hardware must be sufficiently tightened to ensure it does not come loose.
- Recommended tube/tire inflation pressure is on the tire sidewall.

Pivot Bolt:

- Pivot bolt must be correctly and securely installed to ensure it does not come loose.

Steering Function:

- Ensure the Steering Levers move freely, front to back and all attaching hardware is securely tightened.

Seat:

- Secure the seat adjustment bolts each time the seat is moved.



WARNING: This unit has no brakes - Operator back-pedals to slow or stop.

IF YOU HAVE ANY QUESTIONS REGARDING THE OPERATION OF THIS PRODUCT, PLEASE REFER TO THIS OWNERS MANUAL OR CALL CONSUMER SERVICE



IMPORTANT!! Read All Warning And Safety Information on following page!

Warning and Safety Information - continued**WARNING - TO AVOID SERIOUS INJURY:**

- CHOKING HAZARD. Small parts. Not for children under 3 years.
- Never ride with more than one person.
- Adult assembly is required.
- Continuous adult supervision is required.
- Models with Brakes: The brake may be hot after continuous use. Do not touch after braking.
- Ensure rider can reach the pedals through full range of motion.
- Always wear a CPSC approved helmet while riding, with the chinstrap securely fastened.
- Always wear shoes when riding.
- Ride on smooth paved surfaces. Do not ride on streets or roadways.
- Always comply with local laws and regulations.
- Never use near motor vehicles.
- Do not ride on hills, steeply sloped areas, on or near steps, near swimming pools, or in alleys.
- Do not ride the product at dusk, at night or at times of limited visibility.
- Do not ride off road, on grass or wet surfaces.
- Do not ride the product over curbs or bumps that can damage the steering mechanism.
- Do not wear headphones or anything else that would impair your ability to hear or see.
- Do not jump or ramp product.
- Do not tow the product.
- Do not pull any objects with the product.
- Do not push the product.
- Excessive weight may cause a hazardous or unstable condition.
- Understand all operating procedures before riding.
- Do not add a motor to the product.
- Do not modify the product.
- Before each ride check all screws, fasteners and brakes; re-tighten any that are loose. Replace any fasteners that are damaged.
- Handlebar hand grip or tube end plugs should be replaced if damaged as bare tubes have been known to cause injury. All products with capped handlebar ends should be checked regularly to ensure that adequate protection for the ends of the handlebars are in place.
- Replacement forks must have the same rake and tube inner diameter as the original product.
- Know your limits. Be familiar with your abilities. Use common sense.
- Replace worn or broken parts immediately.
- If anything does not operate properly, discontinue use.

Lubrication**WARNING:**

- Do not over lubricate. If oil gets on pedals, injury to the rider or to others can occur.
- Keep all oil off the surfaces of the pedals where your feet rest.
- Using soap and hot water, wash all oil off the wheels, the pedals, and the tires.
- Rinse with clean water and dry completely before you ride the model.
- Using a light machine oil (20W), lubricate the model according to the following table:

Lubrication Table

What	When	How
Pedals	every six months	Put four drops of oil where the axles go into the pedals.

Tires

Maintenance:

- Frequently check the tire inflation pressure because all tires lose air slowly over time. For extended storage, keep the weight off the tires.
- Do not use unregulated air hoses to inflate the tire/tubes. An unregulated hose can suddenly over inflate tires and cause them to burst.
- Replace worn tires.

⚠ WARNING: Do not ride or sit on the unit if a tire is under inflated. This can damage the tire, inner tube and rim.

Inflating the Tires:

- Use a hand or a foot pump to inflate the tires.
- Service station meter-regulated air hoses are also acceptable.
- The maximum inflation pressure is shown on the tire sidewall.
- If two inflation pressures are on the tire sidewall, use the higher pressure for on-road riding and the lower pressure for off-road riding.
- The lower pressure will provide better tire traction and a more comfortable ride.

Before adding air to any tire, make sure the edge of the tire (the bead) is the same distance from the rim, all around the rim, on both sides of the tire. If the tire does not appear to be seated correctly, release air from the inner tube until you can push the bead of the tire into the rim where necessary. Add air slowly and stop frequently to check the tire seating and the pressure, until you reach the correct inflation pressure.

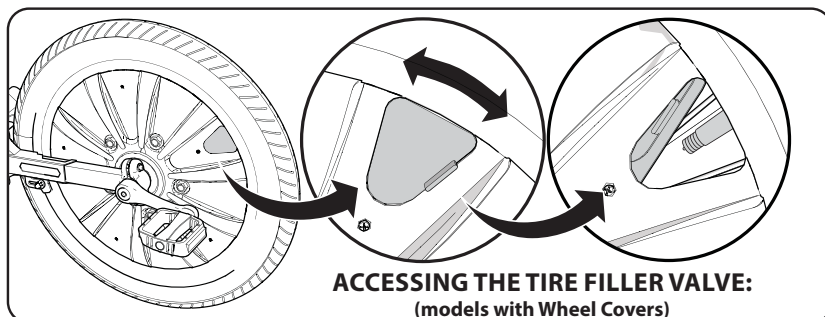
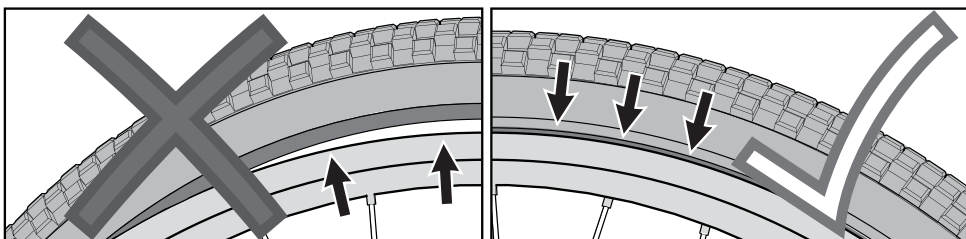

Helmet Warning Information

⚠ WARNING:
ALWAYS WEAR YOUR HELMET
WHEN RIDING THIS PRODUCT!

- Helmet should sit level on your head and low on your forehead. Exposed forehead can result in serious injury.
- Adjust the strap sliders below the ear on both sides.
- Buckle the chin strap. Adjust strap until it is snug.
- No more than two fingers should fit between the strap and your chin.
- A proper fitting helmet should be comfortable and not rock forward/backward or side to side.

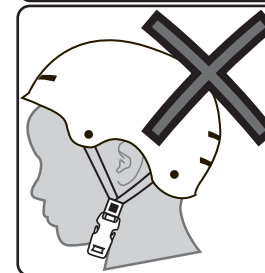
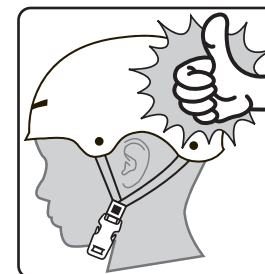

Assembly Notes

The instructions in this manual refer to the right and left side of the product, these are defined from the rider position. Do not discard any parts until the unit is completely assembled.

NOTE: Check Front Tire Pressure before first ride!

Required Tools

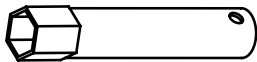

Socket (supplied)



Adjustable Wrench

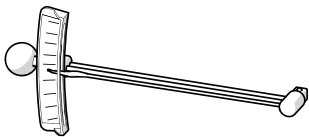

Metric Allen Wrench (supplied)

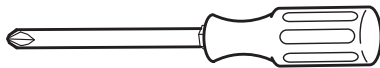

Phillips Screwdriver

Torque Wrench (recommended)

Owner's Model Identification Record

NOTE: This information is only available with model itself. It is not available from Huffy.
 Model number is on the packaging and instruction manual.
 Write the model number below to keep it for future reference.
 If the model is stolen, give this number and a description of the model to the police. This will help them find the model.

Model Number: _____

Purchase Date: _____

Model Name: _____

Repair and Service

WARNING:

- Inspect the product frequently. Failure to inspect the product and to make repairs or adjustments, as necessary, can result in injury to the rider or to others. Make sure all parts are correctly assembled and adjusted as written in this manual and any "Special Instructions".
- Immediately replace any damaged, missing, or badly worn parts with original equipment.
- Make sure all fasteners are correctly tightened as written in this manual and any "Special Instructions". Parts that are not tight enough can be lost or operate poorly. Over tightened parts can be damaged. Make sure any replacement fasteners are the correct size and type.

NOTE: Have a bicycle service shop make any repairs or adjustments for which you do not have the correct tools or if the instructions in this manual or any "Special Instructions" are not sufficient for you.

Installing Pedals

1. Install the pedal marked **R** (Right) on the right side. Tighten clockwise as shown.
2. Install pedal marked **L** (Left) on the left side. Tighten counterclockwise as shown.
3. Make sure threads of each pedal are fully into crank arm.
4. Tighten securely.

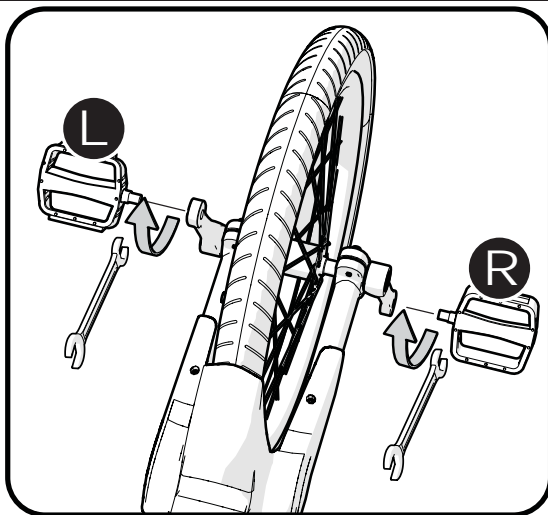

Suggested Handling Methods:

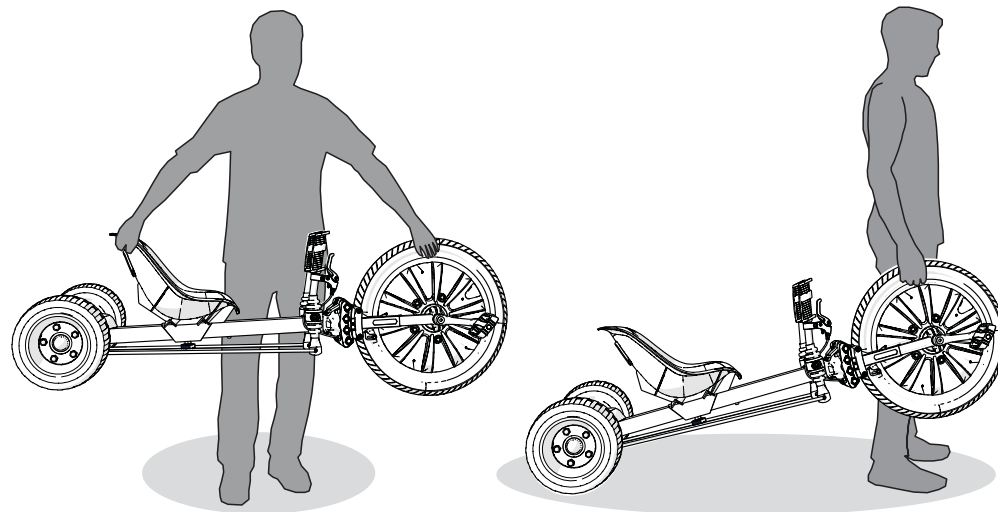

Installing Pivot Bolt Cover

STEPS:

NOTE: Screws **C** maybe pre-installed in Rear Axle Plate **B**. Remove and set aside.

1. Place Pivot Bolt Cover **A** over Rear Axle Plate **B** so that mounting holes line up.
2. Install two Screws **C** through Cover and into Rear Axle Plate.
3. Install Screws securely. No not over tighten.

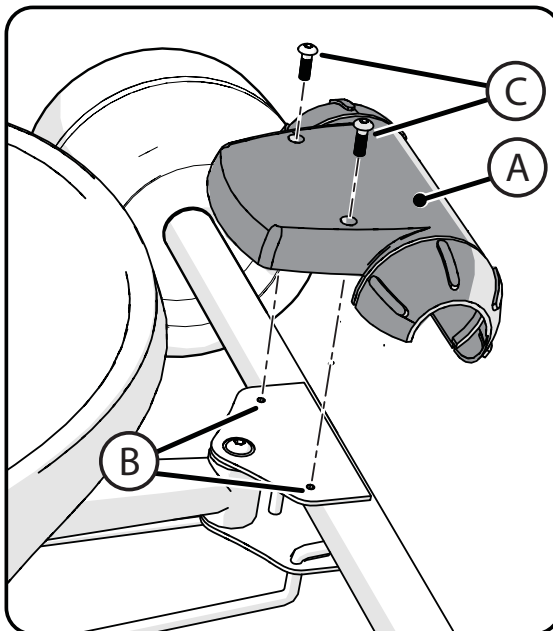

Operation: Steering your Green Machine

STEERING FUNCTION:

- Pulling back on the left lever, and pushing forward on the right lever will turn the product towards the left.
- Pulling back on the right lever, and pushing forward on the left lever will turn the product towards the right.
- Steering this product takes some practice. Ensure the rider can properly steer the product. Practice in an open area.

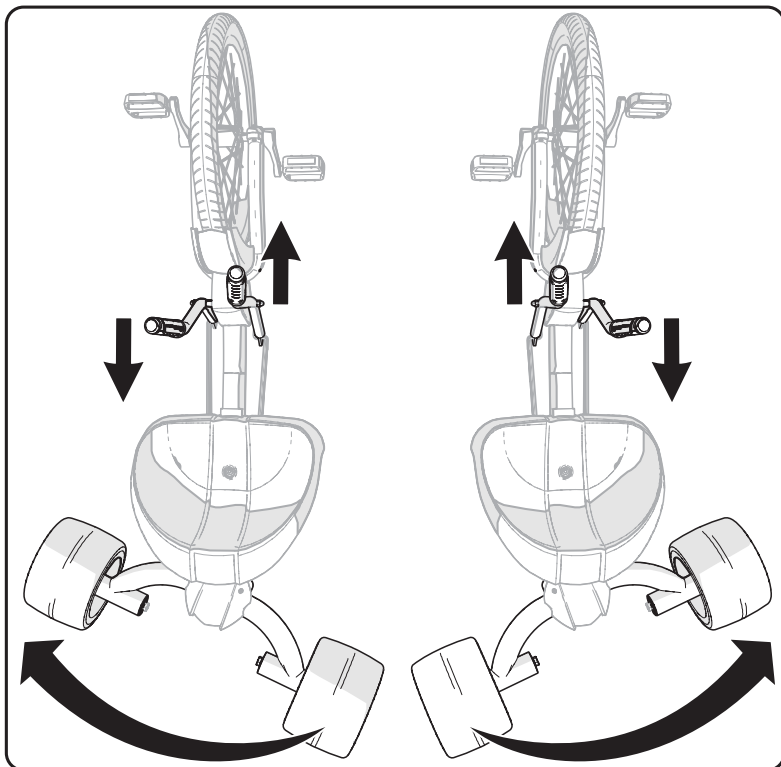

Installing Seat

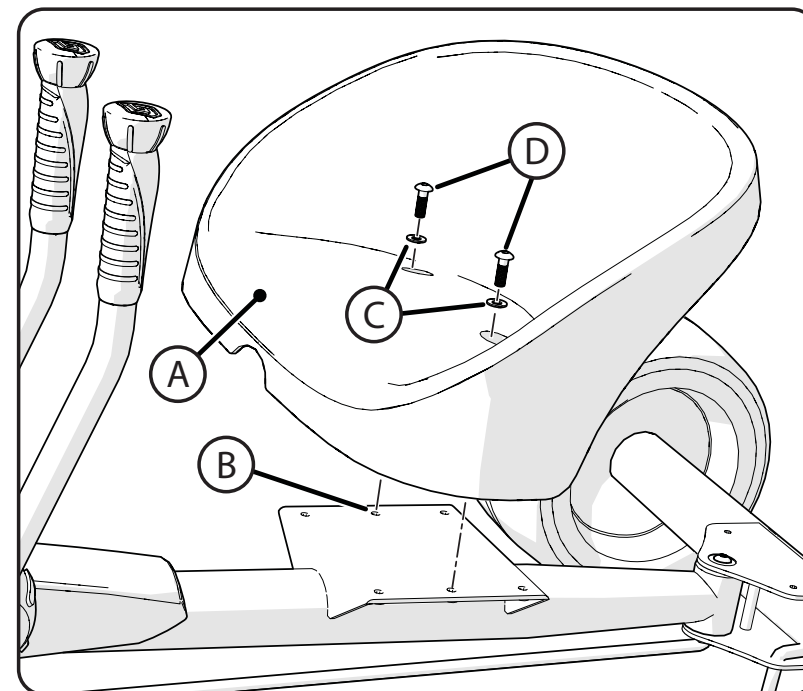

STEPS:

1. Place Seat **A** over Frame Seat Holes **B** (adjust Seat position for proper fit).
2. Insert Washer **C** and Screws **D** through Seat as shown.
3. Tighten Screws securely. Do not over tighten. This can damage the Seat.

NOTES:

- Seat styles may vary.



WARNING: Adjust Seat so that rider can fully use Pedals safely.

Installing Rear Wheels

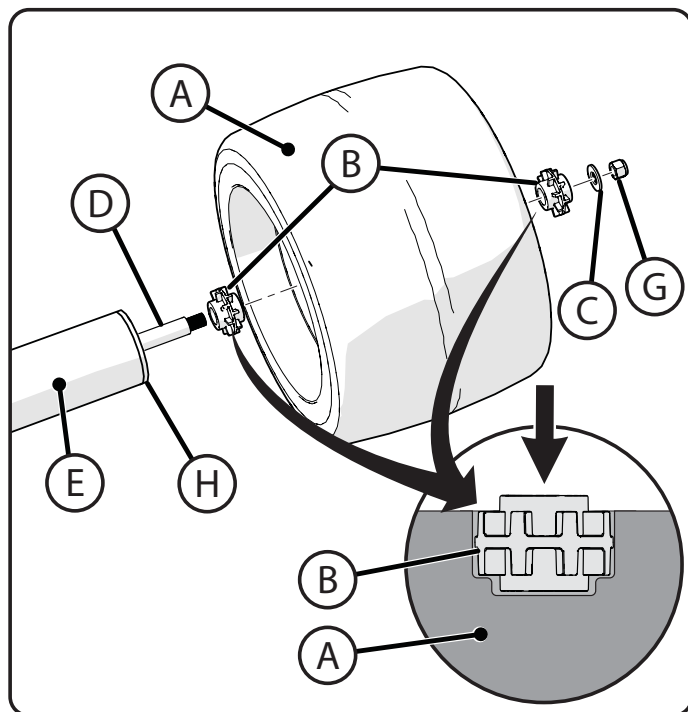

! WARNING:

- Ensure Axle Bolt Threads are fully through the Lock Nuts.
- Ensure Wheels spin freely and evenly and are not loose side to side.

STEPS:

1. Insert a Bushing (B) in both Wheel Axle Holes. **Ensure Bushing is fully seated in the wheel. (Bushings may be pre-installed)**
2. Position Wheel (A) with inset graphic facing outwards.
3. Place a Washer (C) and Lock Nut (G) on one end of Axle Rod (D). Insert Axle Rod through Frame (E).
4. Place Wheel/Bushing assembly over end of Axle (D) making sure Bushings (B) do not come loose. - Ensure Frame Bushings (H) remain in place.
5. Install Washer (C) and Lock Nut (G) onto Axle.
6. Tighten Lock Nut securely.
7. Repeat steps for opposite side wheel.

Operation: Leaning into a Turn



WARNING: Failure to lean in the direction of the turn as shown can result in the unit rolling over.

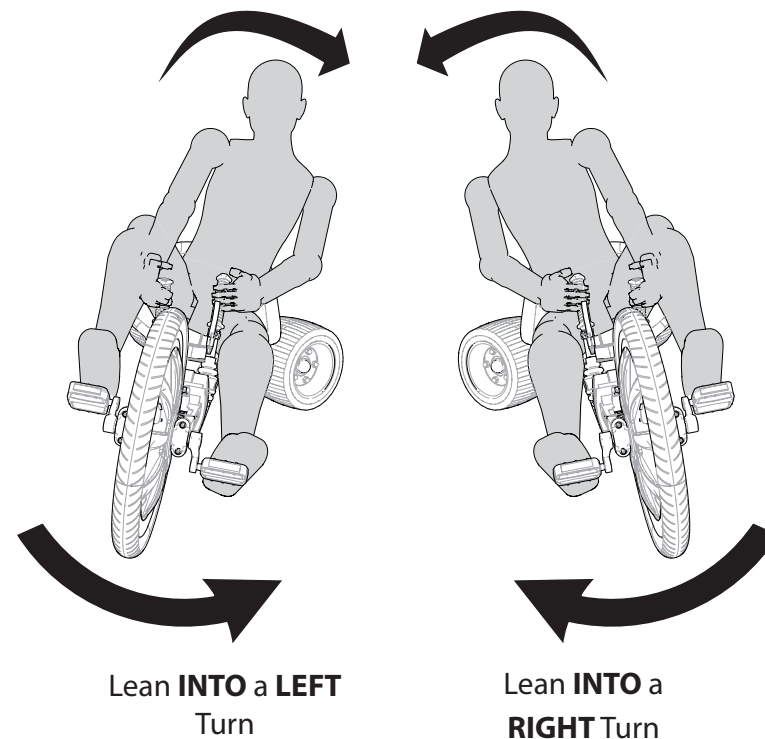

Parts Assembly View

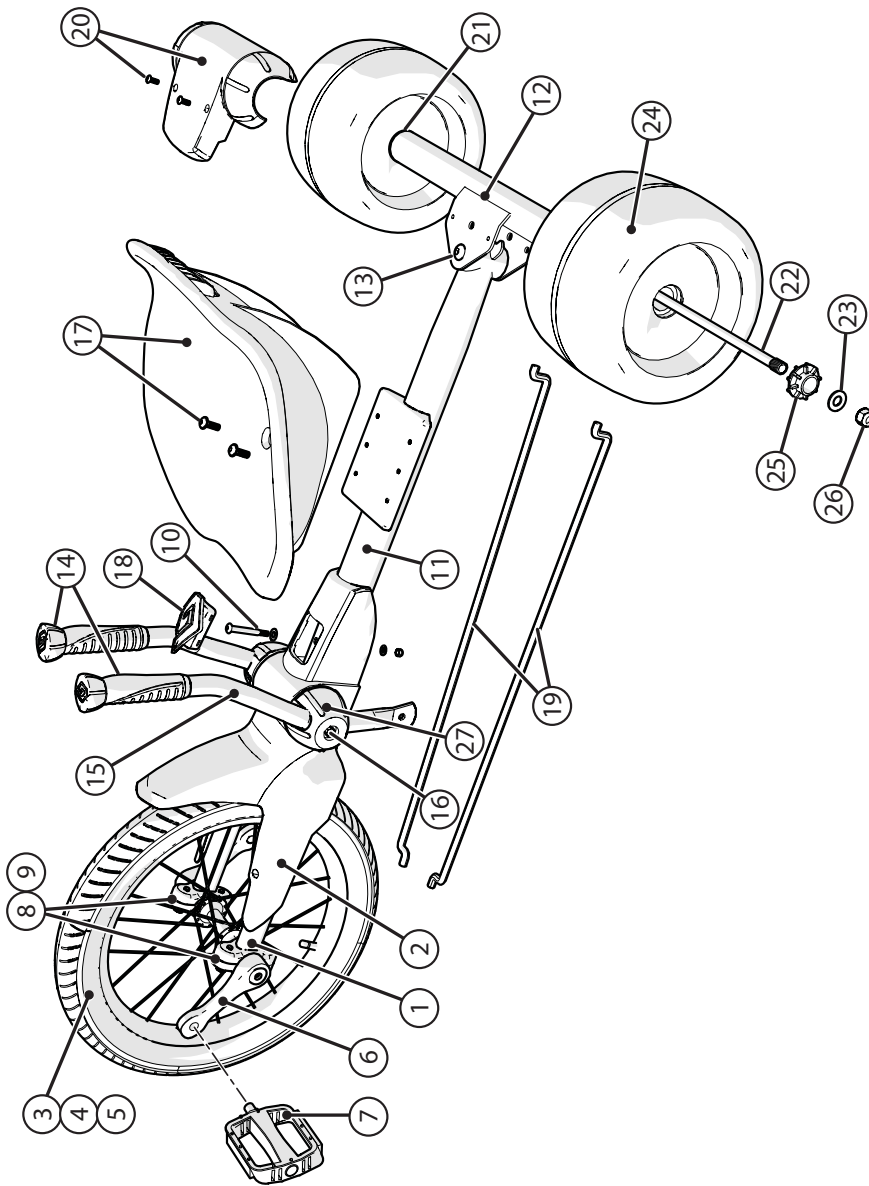

Assemble Rear Steering Axle

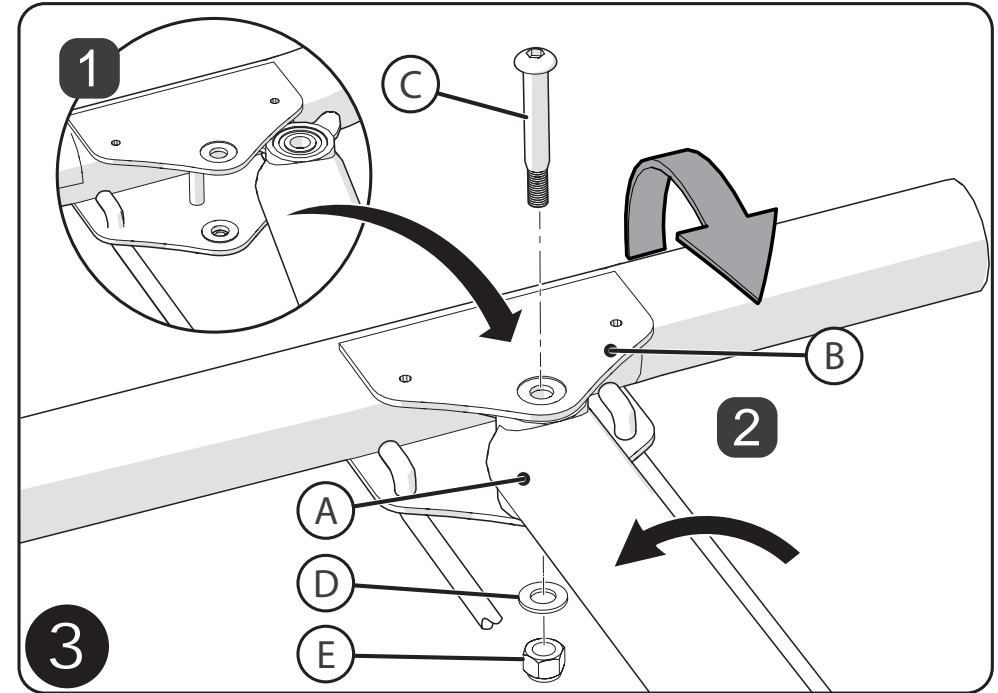

STEP 3:

1. Rotate Rear Axle back to horizontal, while moving Frame (A) into place between Pivot Bracket holes (B).
2. Swing the Frame (A) into the Pivot Bracket (B) so the mounting holes line up.
3. Install Pivot Bolt (C) through Pivot Bracket and Rear Frame pivot end.
4. Install Washer (D) and Locknut (E) onto Pivot Bolt.
5. Tighten Locknut securely.

! WARNING: Periodically check Pivot Bolt Nut for tightness. If the Pivot Bolt comes loose, damage to the product or rider injury may occur.

See Torque Table for Recommended Torque

Attaching Steering Linkage - Rear

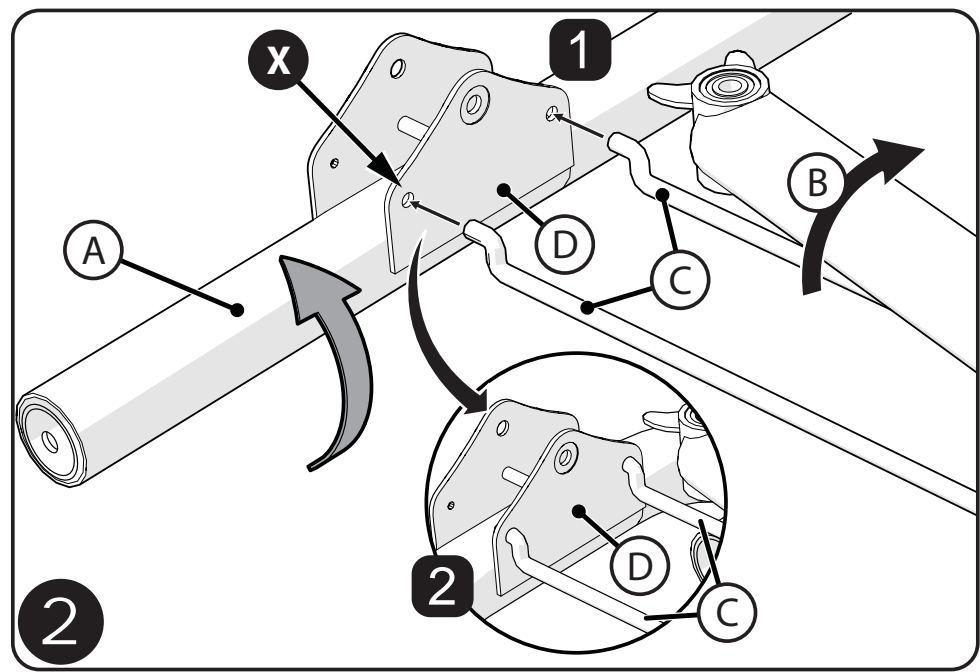

STEP 2:

NOTE: Larger holes on bottom X.

- 1. Rotate Rear Axle (A) UP 90°.
- 2. Move Frame (B) slightly to the side.
- 3. Insert both Steering Rods (C) into Pivot Bracket holes (D) as shown.
- 4. **PROCEED TO NEXT STEP >>**

Parts Assembly List

No.	Description	No.	Description
1	Forward Frame/Fork	15	Steer Levers (left / right)
2	Forward Cowling	16	Steering Lever Bolt Hardware
3	Tire	17	Seat and Mount Hardware
4	Tube	18	Cowl Badge Cover
5	Rim	19	Steering Links (Left and Right)
6	Crank Set	20	Rear Fairing / hardware
7	Pedals (left / right)	21	Frame Bushings (x2)
8	Fork Wheel Clamp (1 each side)	22	Axle Rod
9	Fork Wheel Bushing (2 each side)	23	Axle Washer (x2)
10	Frame Mount Hardware	24	Rear Wheel (x2)
11	Rear Frame	25	Wheel Bushings (x4)
12	Rear Axle Frame	26	Axle Locknut (x2)
13	Rear Axle Mount Hardware	27	Steering End Caps
14	Grips (x2)	28	Wheel Cover Pair (not shown)

Assemble Front Frame to Rear Frame

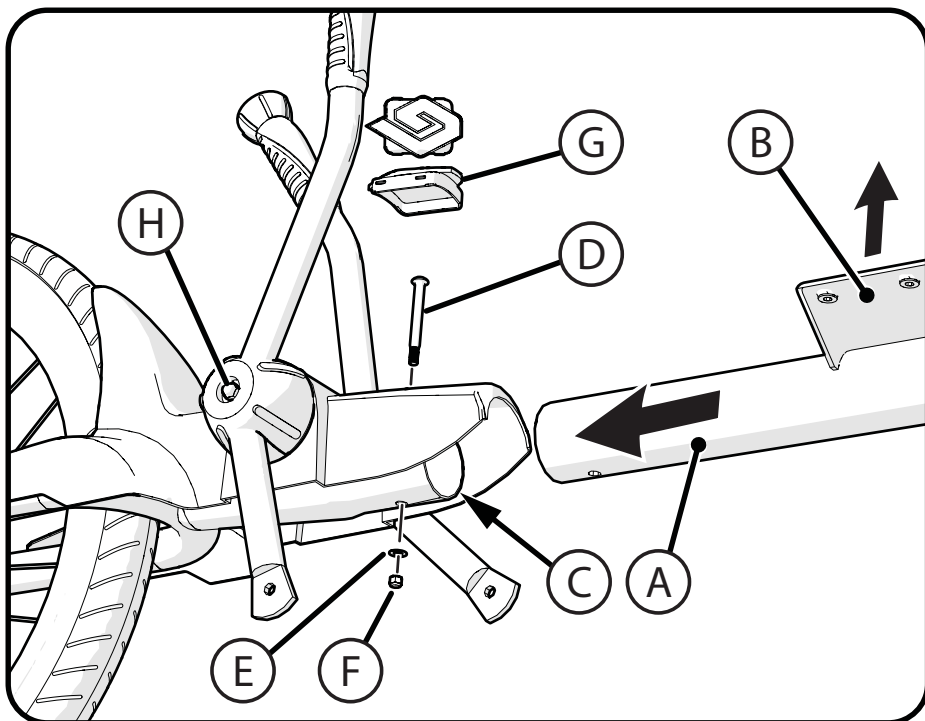

STEPS:

NOTE: Begin by turning rear Frame (A) so that Seat Plate (B) faces UP.

1. Insert forward Frame Tube (C) into rear Frame (A) until mounting holes line up.
2. Insert frame Bolt (D) down through cowl and through both frame tubes.
3. Install Washer (E) and Locknut (F). Tighten Bolt and Locknut fully and securely.
4. Snap Cowl Badge (G) firmly into place.

NOTE: Periodically check tightness of Steer Lever Locknuts (H) (both sides).

Attaching Steering Linkage - Front

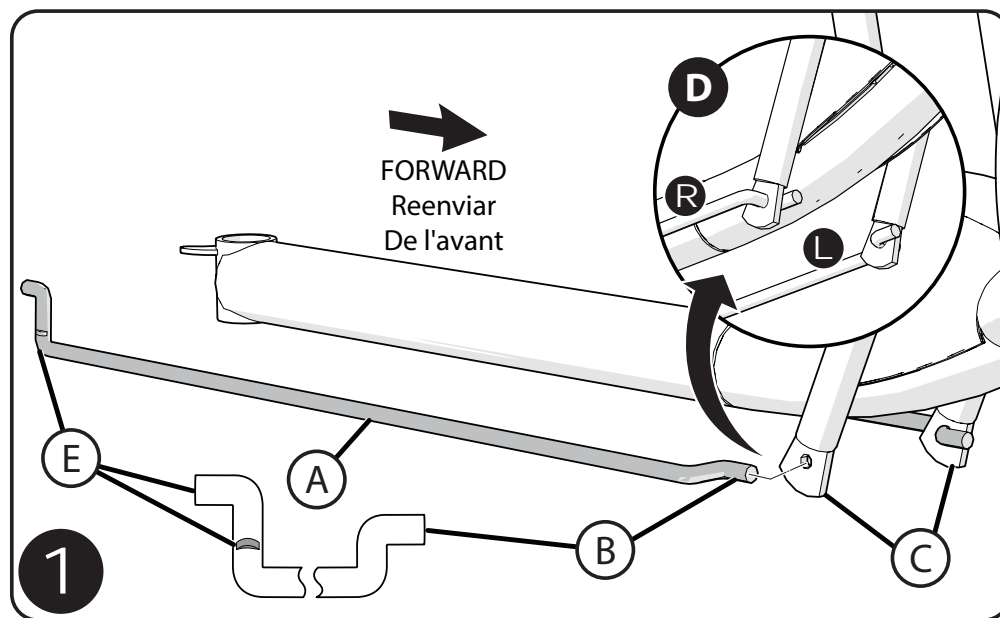

STEP 1:

1. Insert end of **Right** Steering Rod (A) with SHORTER End (B) into Steering Rod Handle Ends (C) as shown on right side of unit.
2. Make sure Rods are on the OUTSIDE (view (D) of the Steering Rods as shown and back of Rods (with Notch/Tabs) are pointing UP (E).
3. Repeat on left side.
4. **PROCEED TO NEXT STEP >>**